

vtech[®]

User's Manual

Pretend & Discover Doctor's Kit[™]



© 2016 VTech
Printed in China
91-003218-000 (US)

Dear Parent,

At **VTech**[®], we know how important the first day of school is for your child. To help prepare preschoolers for this important event, **VTech**[®] has developed the **Preschool Learning**[™] series of interactive toys.

Preschool Learning[™] features fun characters and inviting school themes that use technology to capture a child's attention and teach important preschool skills like spelling, counting and the alphabet. These vital skills are taught in a way that's both fun and highly engaging to maintain a child's interest. Children will also be introduced to fun school subjects such as art class, music class and even recess! With **Preschool Learning**[™], learning is fun from day one!

At **VTech**[®], we know that a child has the ability to do great things. That's why all of our electronic learning products are uniquely designed to develop a child's mind and allow them to learn to the best of their ability. We thank you for trusting **VTech**[®] with the important job of helping your child learn and grow!

Sincerely,

Your friends at **VTech**[®]

To learn more about **VTech**[®] toys, visit vtechkids.com

INTRODUCTION

Thank you for purchasing the **VTech® Pretend & Discover Doctor's Kit™**. This medical playset includes five medical tools, two patient cards and a storage case for fun on the go. Three activities introduce colors, body parts, fun medical facts and more!



INCLUDED IN THIS PACKAGE

- One VTech® Pretend & Discover Doctor's Kit™
- Tool accessories: bandage, otoscope, stethoscope, syringe and thermometer
- Two double-sided patient cards
- User's manual

WARNING: All packing materials, such as tape, plastic sheets, wire ties and tags are not part of this toy, and should be discarded for your child's safety.

ATTENTION: Pour la sécurité de votre enfant, débarrassez-vous de tous les produits d'emballage tels que rubans adhésifs, feuilles de plastique, attaches et étiquettes. Ils ne font pas partie du jouet.

NOTE: Please keep this user's manual as it contains important information.

Unlock the packaging locks:

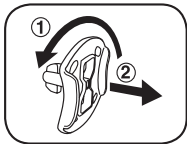

1. Rotate the packaging lock 90 degrees counterclockwise.
2. Pull out the packaging lock and discard.

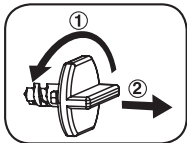

1. Turn the packaging lock counterclockwise several times.
2. Pull out and discard the packaging lock.

GETTING STARTED

BATTERY INSTALLATION

1. Make sure the unit is turned **OFF**.
2. Locate the battery cover on the bottom of the unit.
3. Use a screwdriver to loosen the screw and open the battery cover.
4. Install 2 new “AA” (LR6/AM-3) batteries into the battery box as illustrated. (The use of new, alkaline batteries is recommended for maximum performance.)
5. Replace the battery cover and tighten the screw to secure.

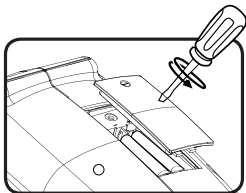

BATTERY NOTICE

- Use new alkaline batteries for maximum performance.
- Use only batteries of the same or equivalent type as recommended.
- Do not mix different types of batteries: alkaline, standard (carbon-zinc) or new and used batteries.
- Do not use damaged batteries.
- Insert batteries with the correct polarity.
- Do not short-circuit the battery terminals.
- Remove exhausted batteries from the toy.
- Remove batteries during long periods of non-use.
- Do not dispose of batteries in fire.
- Do not charge non-rechargeable batteries.
- Remove rechargeable batteries from the toy before charging (if removable).
- Rechargeable batteries are only to be charged under adult supervision.

PRODUCT FEATURES

1. OFF/ACTIVITY SLIDER

Move the **OFF/ACTIVITY SLIDER** to select an activity to play. To turn the unit **OFF** move the slider to **OFF**.



2. LIGHT-UP TOOL BUTTONS

Press the **LIGHT-UP TOOL BUTTONS** to learn medical tool names, colors, fun facts or answer the questions in related activities.



3. ROLLING BALL

Spin the **ROLLING BALL** to hear melodies and sing-along songs, learn fun medical facts or get helpful hints in related activities. The eyes will also move when rolling the ball.

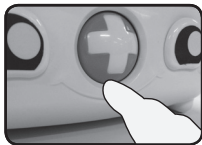

4. DOUBLE-SIDED PATIENT CARDS

Insert either card into the slot to perform guided exams. The doctor's kit will ask you to find and use the medical tools to treat patients in addition to introducing body parts and playing songs.

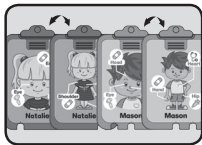

5. COVER

Open or close the **COVER** to hear fun responses.



6. VOLUME CONTROL SWITCH

Slide the **VOLUME CONTROL SWITCH** to the right for high volume or slide to the left for low volume.



7. ACCESSORIES

Use the **BANDAGE**, **OTOSCOPE**, **STETHOSCOPE**, **SYRINGE** and **THERMOMETER** for role-play fun.



8. AUTOMATIC SHUT-OFF

To preserve battery life, the **VTech® Pretend & Discover Doctor's Kit™** will automatically power down after several minutes without input. The unit can be turned on again by sliding the **OFF/ACTIVITY SLIDER** to any of the 3 modes.

ACTIVITIES

Activity 1: Learning Mode

Move the **ACTIVITY SLIDER** to the second position  to enter this mode. Press any **TOOL BUTTON** to learn the tool's name, facts and colors. Spin the **ROLLING BALL** to learn fun medical facts. Insert a **PATIENT CARD** to perform an exam and treat the patient.

Activity 2: Quiz Mode

Move the **ACTIVITY SLIDER** to the third position  to enter this mode. The doctor's kit will ask a series of questions about tools, facts or colors. When a **PATIENT CARD** is inserted, it will ask questions about the patient. Press the **TOOL BUTTONS** to answer.

Activity 3: Music Fun

Move the **ACTIVITY SLIDER** to the fourth position  to enter this mode. Spin the **ROLLING BALL** to hear fun medical songs or melodies. Press any of the **TOOL BUTTONS** to add silly sounds into the songs, and watch the lights flash with the music!

SONG LIST

SONG 1

Going to the doctor is no big deal
Doctors and nurses want to help you heal
Be sure to tell them how you feel
So you can stay healthy happily

SONG 2

Head, shoulders, knees and toes, knees and toes
Head, shoulders, knees and toes, knees and toes
And eyes and ears and mouth and nose
Head, shoulders, knees and toes, knees and toes

SONG 3

I'm just what the doctor ordered, I'm a medical kit!
House calls and helping people make me smile
So does playing with you for awhile

SONG 4

Doctors need tools to do their job
An otoscope to see in your mouth, say "ahhhh"
A stethoscope to hear your heart beat
Doctors' tools can be really neat

CARE & MAINTENANCE

1. Keep the unit clean by wiping it with a slightly damp cloth.
2. Keep the unit out of direct sunlight and away from any direct heat source.
3. Remove the batteries when the unit is not in use for an extended period of time.
4. Do not drop the unit on hard surfaces and do not expose the unit to moisture or water.

TROUBLESHOOTING

If for some reason the program/activity stops working or malfunctions, please follow these steps:

1. Please turn the unit **OFF**.
2. Interrupt the power supply by removing the batteries.
3. Let the unit stand for a few minutes, then replace the batteries.
4. Turn the unit **ON**. The unit should now be ready to play again.
5. If the product still does not work, replace with a new set of batteries.

If the problem persists, please call our Consumer Services Department at 1-800-521-2010 in the U.S., or 1-877-352-8697 in Canada, or by going to our web site at www.vtechkids.com and filling out our Contact Us form located under the Customer Support link. A service representative will be happy to help you.

IMPORTANT NOTE:

Creating and developing **VTech**[®] products is accompanied by a responsibility that we at **VTech**[®] take very seriously. We make every effort to ensure the accuracy of the information which forms the value of our products. However, errors sometimes can occur. It is important for you to know that we stand behind our products and encourage you to call our Consumer Services Department at 1-800-521-2010 in the U.S., or 1-877-352-8697 in Canada with any problems and/or suggestions that you might have. A service representative will be happy to help you.

NOTE:

This equipment has been tested and found to comply with the limits for a Class B digital device, pursuant to Part 15 of the FCC Rules. These limits are designed to provide reasonable protection against harmful interference in a residential installation. This equipment generates, uses and can radiate radio frequency energy and, if not installed and used in accordance with the instructions, may cause harmful interference to radio communications. However, there is no guarantee that interference will not occur in a particular installation. If this equipment does cause harmful interference to radio or television reception, which can be determined by turning the equipment off and on, the user is encouraged to try to correct the interference by one or more of the following measures:

- Reorient or relocate the receiving antenna.
- Increase the separation between the equipment and receiver.
- Connect the equipment into an outlet on a circuit different from that to which the receiver is connected.
- Consult the dealer or an experienced radio/TV technician for help.

Caution: Changes or modifications not expressly approved by the party responsible for compliance could void the user's authority to operate the equipment.





PRODUCT WARRANTY

This Warranty is applicable only to the original purchaser, is non-transferable and applies only to "VTech" products or parts. This product is covered by a 3-month Warranty from the original purchase date, under normal use and service, against defective workmanship and materials. This Warranty does not apply to (a) consumable parts, such as batteries; (b) cosmetic damage, including but not limited to scratches and dents; (c) damage caused by use with non-VTech products; (d) damage caused by accident, misuse, unreasonable use, immersion in water, neglect, abuse, battery leakage, or improper installation, improper service, or other external causes; (e) damage caused by operating the product outside the permitted or intended uses described by VTech in the owner's manual; (f) a product or part that has been modified (g) defects caused by normal wear and tear or otherwise due to the normal aging of the product; or (h) if any VTech serial number has been removed or defaced.

Prior to returning a product for any reason, please notify the VTech Consumer Services Department by going to our web site at www.vtechkids.com, filling out our Contact Us form located under the Customer Support link or calling 1-800-521-2010.

If VTech believes that there may be a defect in the materials or workmanship of the product and can confirm the purchase date and location of the product, we will at our discretion replace the product with a new unit or product of comparable value. A replacement product or parts assumes the remaining Warranty of the original product or 30 days from the date of replacement, whichever provides longer coverage.

THIS WARRANTY AND THE REMEDIES SET FORTH ABOVE ARE EXCLUSIVE AND IN LIEU OF ALL OTHER WARRANTIES, REMEDIES AND CONDITIONS, WHETHER ORAL, WRITTEN, STATUTORY, EXPRESS OR IMPLIED. IF VTECH CANNOT LAWFULLY DISCLAIM STATUTORY OR IMPLIED WARRANTIES THEN TO THE EXTENT PERMITTED BY LAW, ALL SUCH WARRANTIES SHALL BE LIMITED TO THE DURATION OF THE EXPRESS WARRANTY AND TO THE REPLACEMENT SERVICE AS DETERMINED BY VTECH IN ITS SOLE DISCRETION.

To the extent permitted by law, VTech will not be responsible for direct, special, incidental or consequential damages resulting from any breach of Warranty.

This Warranty is not intended to persons or entities outside the United States of America. Any disputes resulting from this Warranty shall be subject to the final and conclusive determination of VTech.